

## **Duct Seaming Machine DuctZipper RAS 20.10 in "L" shape**

Material thickness range	0.5-1 mm	26-20 Ga
Min. duct cross section	120 x 120 mm	4.7" x 4.7"
at 400 N/mm <sup>2</sup> / 58.000 PSI tensile strength		
Total length	5720 mm	225"



RAS technology and engineering have taken the seaming process from the traditional three steps, down to only one. In the past you had three different working steps: rollforming the receiver lock, rollforming or braking the flange and then closing the seam. The DuctZipper does it all in one smooth and simple operation!

The result is a clean joint, extremely tight ducts, and remarkably fast throughput.

The Ductzipper in L shape simplify the production of ducts significant!



### **Run-in table**

- Length 2000 mm
- Removable profiles for easy insert of the duct sheets
- Support pillar below run-in table
- Extended guiding rail supports the sheets to the first forming station.

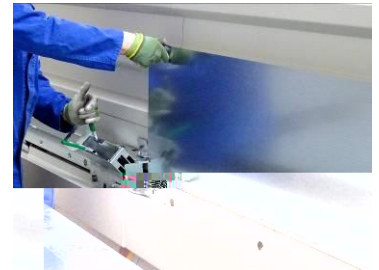

### **Run-out table**

- Length 2350 mm
- For ducts up to 2000 mm length of the Autopilot is still supported by the run-out table.
- Support pillar below run-out table

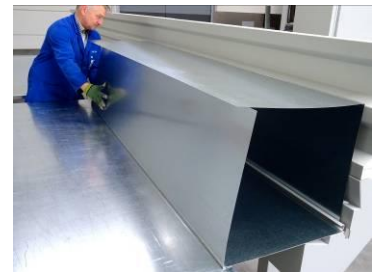

### **Vertical Support wall**

- Support for vertical duct flanges
- Vertical support: 640 mm
- Horizontal support: 200 mm



### Roller set

- The roller set are made of a galvanized steel (0.5-1 mm)
- Easy open panels for maintenance access to the wheels
- Additional shaft seals extend life time of the bearings  
Zinc particles cannot infiltrate the gear box.

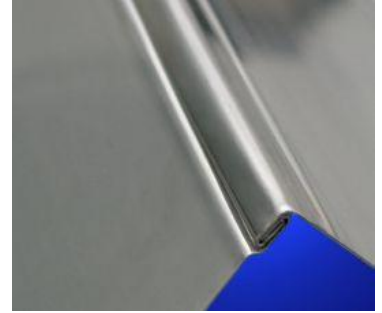

### Electrics

- 400 v, 50 hz, 3 ph
- Connection to power through 5m cable with CEE plug

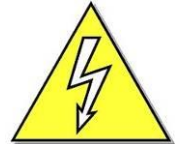

### Safety system

- Cable controlled emergency switch
- Inline circuit breaker preventsunintentional restart after loss of power.



## Options:

### AutoPilot

- clamps the blanks during the run
- The floating lower jaw offers an extremely safe two point clamp on any thickness.
- AutoPilot for DuctZipper in "L" shape



### SealJet

- Easy, fast, efficient and clean seam joint sealing while the ductruns through the DuctZipper.
- SealJet injects an exact amount of the Mez-Bluemastic-Gel sealant.
- Except 5.5 bar (73 PSI) air pressure, the SealJet requires no additional power source.
- A sensor starts the injection process when the duct passes a nozzle and stops immediately after the duct has run through.
- Mez-Bluemastic-Gel is temperature resistant from minus 30°C (minus 22°F) up to 160°C (320°F) and offers protection against corrosion (corrosion grade 0).
- The sealant meets the strictest hygiene requirements of VDI 6022 and EN 15780. Mez-Bluemastic-Gel is available in 25 kg (55 lbs) packaging. Each bin contains enough sealant forsealing about 18,000 meters (59,000 ft) of ductwork.
- The SealJet injection unit can be retrofitted to existing machines!
- The SealJet has been developed for the Mez-Bluemastic-Gel. If other sealants with different characteristics are used, this may lead to a loss of warranty.

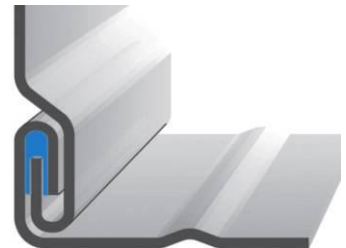
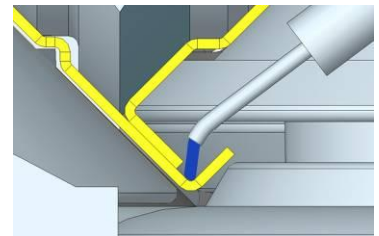

### Spare parts package

- 1x sliding piece for AutoPilot right
- 1x sliding piece for AutoPilot left
- 2x sliding piece

### Spare parts package– SealJet

- 1x sealing made of PVC for Bluemastic-Gel bin